



SHANTUI
VALUE THAT WORKS



山推建友机械股份有限公司 客服电话: 4006-188-199
SHANTUI JANEEO MACHINERY CO.,LTD. Service Hotline: 4006-188-199

山推工程机械股份有限公司 控股子公司

销售电话(Domestic Sale): +86-531-89815377 / 国内电邮(Domestic E-mail): janeoo_yxb@shantui.com
外贸电话(Overseas Sale): +86-531-89815067 / 外贸电邮(Overseas E-mail): janeoo_wmb@shantui.com
配件电话(Accessory Sale): +86-531-89815077 / 配件电邮(Accessory E-mail): janeoobjb@126.com

传真 (Fax): +86-531-89815068 +86-531-89815268 邮编(Zip): 250022
地址: 山东省济南市段店南路268号 网址(website): www.janeoo.com
Add: NO.268.Duandian South Road, Jinan, Shandong, China, P.R.



SHANTUI - Janeoo
VALUE THAT WORKS



沥青路面搅拌设备
Mixing Plant for Asphalt Pavement

全新上市 — 环保型沥青混合料搅拌设备

New market - environmental protection asphalt mixture mixing equipment

① 冷骨料仓系统 Cold Aggregate Bins

1. 单体组合式冷骨料仓并行排列，料仓数量可在标配数量基础上增减；
2. 料斗上部配有格栅防止超大骨料及杂物进入；
3. 料斗顶部设置防尘罩，自动将装载机送料过程中产生的粉尘送入除尘系统或送入专用的冷料除尘系统；
4. 皮带给料机变频控制，根据配比要求和产量设定进行自动或手动调节；
5. 配置断料声光报警器；
6. 两个细料仓配有振动破拱。

- 1.The integrally combined cold aggregate bins are arranged in parallel and the number of cold aggregate bins can be increased or reduced based on the number of standard configuration.
- 2.The bins are installed with gratings on the top to prevent the ingress of super-large aggregates and debris.
- 3.The bins are installed with dust covers on the top so that the dusts generated during the feeding of the loaders are automatically conveyed to the dedusting system or the special cold material dedusting system.
- 4.The belt feeder with variable frequency control allows the automatic or manual adjustment based on the proportioning requirement and output setting.
- 5.A feeding interruption sound-light alarm is installed.
- 6.Two fine aggregate bins are installed with vibratory arch breaker.

② 干燥滚筒系统 Drying Drum

利用最新技术研发的新一代高效节能干燥滚筒，料帘结构进一步优化，加热更均匀，热能利用率更高。

- 1.采用四台国际知名品牌轴装式减速机驱动，摩擦传动，动力强劲，功耗低；
- 2.特殊设计的滚筒燃烧区和冷热料帘分区，物料加热效率>90%，骨料加热更快更充分；
- 3.滚筒外包保温绝热材料和高强度不锈钢蒙皮，防止热量散失，进一步提高热效率；
- 4.长寿命耐磨滚圈和扬料叶片，滚筒筒身选用耐磨炉板。

The new generation high-efficiency energy-saving drying drum is developed with latest technologies to further optimize the material curtain structure and realize more uniform heating and higher thermal energy utilization.

1. Driven via friction drive by four shaft-installed reduction motors of world's renowned brand, the drying drum features strong power and low power consumption.
- 2.The drum combustion zone and cold/hot material curtain partition are specially designed to achieve >90% material heating efficiency and faster and more sufficient aggregate heating.
- 3.The drum is externally wrapped with thermal insulation material and high-strength stainless steel covering to prevent the heat loss and further improve the thermal efficiency.
- 4.The long-life wear-resistant rolling ring and lifting blades are used and the drum body is made of wear-resistant furnace plates.

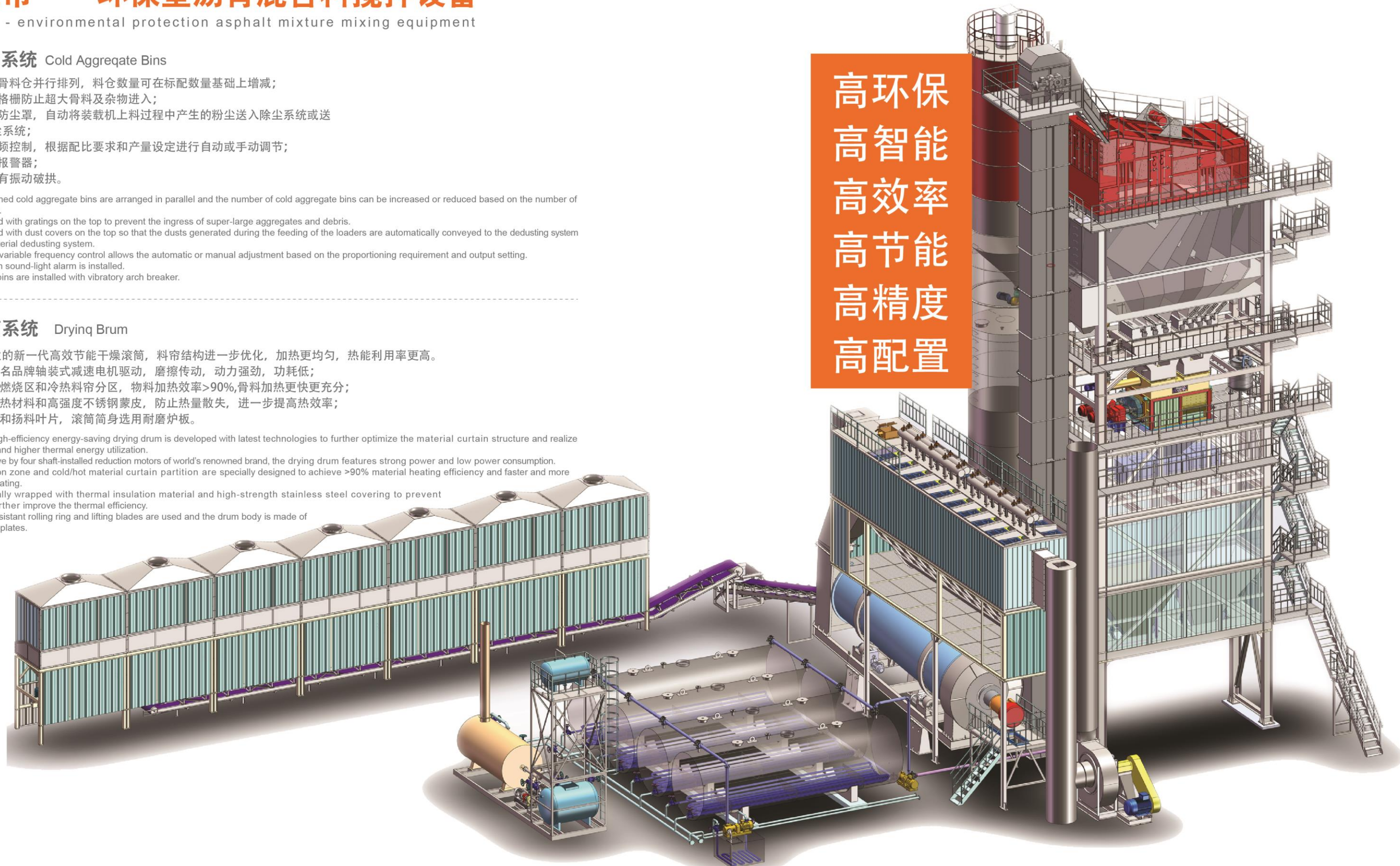

3 燃烧器系统 Main Burner

- 1.基于5G移动控制平台的双变频控制智能燃烧器，调节比范围达1:10；
- 2.温度控制精准骨料加热温度控制在 $\pm 5^{\circ}\text{C}$ 以内；
- 3.低压雾化，以骨料温度为核心的数字化燃烧控制技术，燃烧效率近100%；
- 4.能耗低，噪声低，防雨防尘，实时火焰监测，组合式气阀；高低压燃气监测，双核控制确保安全。

- 1.The intelligent burner with double variable frequency control is based on 5G mobile control platform, with the adjustment ratio range at 1:10.
- 2.The aggregate heating temperature is controlled within $\pm 5^{\circ}\text{C}$, featuring accurate temperature control.
- 3.The digitalized combustion control technology with low-pressure atomization is centered on the aggregate temperature to achieve nearly 100% combustion efficiency.
- 4.It features low energy consumption and noise, dust/rain proof, real-time flame monitoring, and combination gas valves. With high/low pressure gas monitoring, the double-core control guarantees the safety.

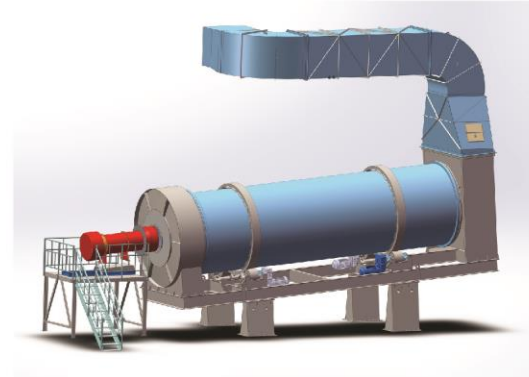

4 振动筛系统 Vibrating Sieve

- 1.拥有专利技术的方箱式直线振动筛，筛分效率 $\geq 95\%$ ，混仓率低于5%；
- 2.进口双振动电机同步驱动，传动效率高，免维护，故障率低；
- 3.筛体外壳岩棉保温，低噪声，保温隔热进一步提高些效率；
- 4.分段式筛网，前后张紧，更换更方便快捷，选用高强度专用筛网，筛网寿命长。

- 1.The box type linear vibrating sieve with patented technologies features $\geq 95\%$ sieving efficiency and $< 5\%$ bin mixing ratio.
- 2.It's synchronously driven by two imported vibrating motors to realize high drive efficiency, maintenance-free, and low failure rate.
- 3.The sieve body is encased by mineral wool to realize thermal insulation and low noise and further improve the efficiency.
- 4.The sectional type sieve is tensioned on the front and rear to better ease the replacement. The special high-strength sieve is used to guarantee long life.

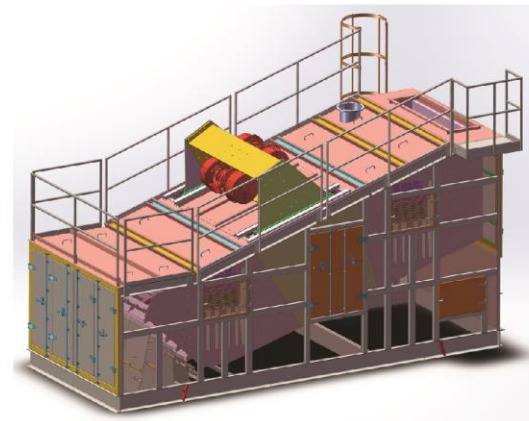

5 热骨料仓系统 Vibrating Hot Aggregate Bins

- 1.超大容量热骨料仓，各分仓容积黄金比例满足规范要求；
- 2.仓体采用耐磨钢板制作，料流冲击部位设置防磨结构；
- 3.各分仓下部均设置独立取样口，方便级配试验取样；
- 4.标配耐磨型连续料位；
- 5.设置溢排料管道和超规格料排料通道。



- 1.The super-large capacity hot aggregate bins are composed of the bins of capacities in golden ratio to meet the specification requirement.
- 2.The bin body is made of wear-resistant steel plates and its material impact portion is installed with wear-resistant structure.
- 3.Every bin is provided with an independent sampling port on the bottom to ease the sampling for the grading test.
- 4.The standard wear-resistant continuous material level indicators are provided.
- 5.The excessive material discharge pipeline and the oversize material discharge pipeline are provided.

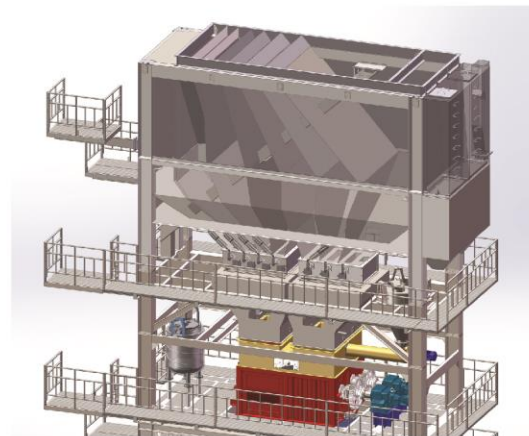

6 计量系统 Metering System

- 1.包含骨料计量、粉料计量和沥青计量；
- 2.骨料计量:双骨料秤平行计量，采用细骨料秤和粗骨料秤同时称量的方式。两个骨秤称各自进行累积计量，且各种物料都包含粗精计量秤，大幅度提高计量速度和计量精度；
- 3.沥青计量:顶吸喷射式二次称量，称量精度业内领先。

- 1.It includes the aggregate metering, powder metering, and asphalt metering.
- 2.Aggregate metering: The double aggregate scale is used for paralleling weighing, namely the fine and coarse aggregate scales are used simultaneously for weighing. Two aggregate scales are used for accumulative weighing respectively and all materials include the coarse and fine weighing scales to remarkably improve the metering speed and accuracy. sistant structure.
- 3.Asphalt weighing: With overhead injection type secondary metering method, the weighing accuracy is leading the industry.

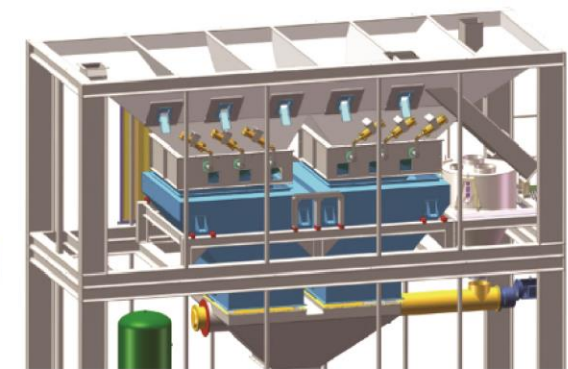
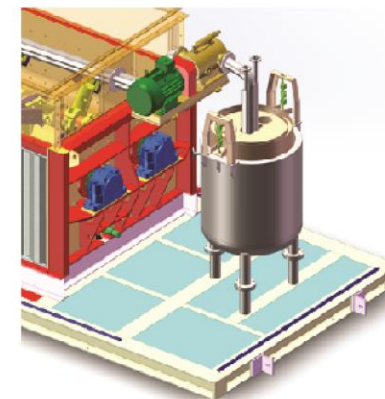

7 搅拌主机系统 Main Mixing Unit

- 1.超大容量搅拌主机，充盈率 ≤ 0.45 ；
- 2.超强的搅拌能力，选用大功率减速电机，具有一定的超载能力；
- 3.物料在罐体内沿轴向、径向和切向三维立体搅动，混合料拌和更均匀，拌料速度更快，不但可以满足各种不同工况的生产需求，功率损耗比原来降低20%。

- 1.The super-high capacity mixing unit realizes ≤ 0.45 filling rate.
- 2.The selected high-power reduction motor features super-strong mixing capability and certain overload capability.
- 3.The materials are mixed three-dimensionally in axial, radial, and tangential directions within the drum to realize more uniform mixing and higher mixing speed of the mixture. It can not only meet the production needs under diversified conditions, but also reduce the power consumption by 20% than the original value.

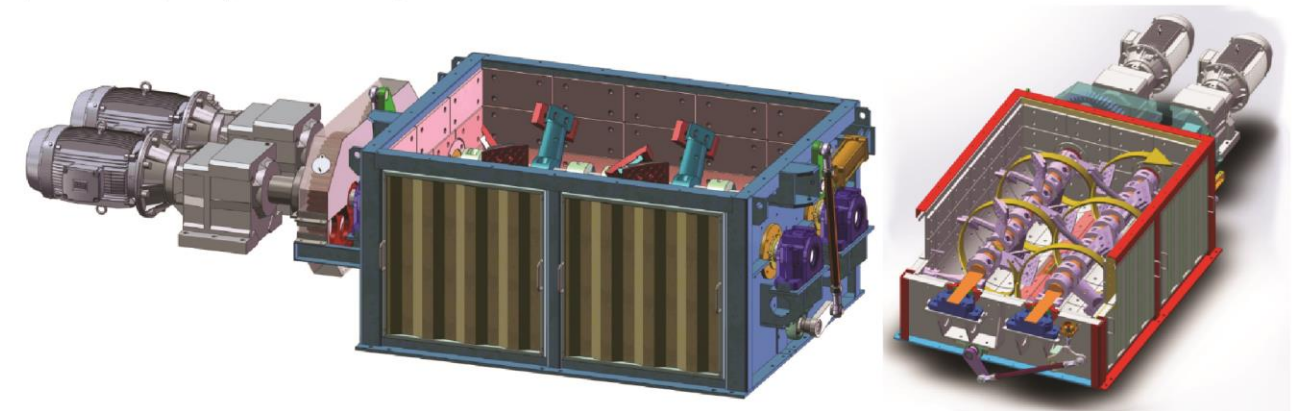



沥青拌合站 / B系列

Asphalt Batching Plant



B系列优点

- ① 模块化结构设计，安装方便，场地布置灵活；
- ② 高效、节能、易维护；
- ③ 计量系统精确、稳定可靠，抗干扰能力强；
- ④ 智能化在线检测油耗，故障自诊断；
- ⑤ 双机双控操作系统，互为备份，关键外购件采用进口品牌，可靠性高。

Benefits of B Series

- ① Modular structure design, convenient installation, flexible site layout;
- ② High efficiency, energy saving and easy maintenance.
- ③ The metering system is accurate, stable and reliable with strong anti-interference ability;
- ④ Intelligent online detection of fuel consumption, fault self-diagnosis;
- ⑤ Dual machine and dual control operating system, mutual backup, imported brand for key purchased parts, high reliability.

型号 Model		LB1000-3B	LB1500-3B	LB2000-3B	LB3000-5B	LB4000-5B	LB5000-5B
额定生产率 Rated productivity (t/h)		80	120	160	240	320	400
搅拌主机容量 Mixer capacity (kg)		1000	1500	2000	3000	4000	5000
称量范围及 计量精度 Weighing range & accuracy	骨料 Aggregate (kg)	1000±0.5%	1500±0.5%	2000±0.5%	3000±0.5%	4000±0.5%	5000±0.5%
	粉料 Powder (kg)	150±0.3%	225±0.3%	300±0.3%	450±0.3%	600±0.3%	800±0.3%
	沥青 Asphalt (kg)	100±0.2%	150±0.2%	200±0.2%	300±0.2%	400±0.2%	500±0.2%
整机功率 Total power (kW)		240	370	420	640	760	805
燃油消耗 Fuel consumption (kg/t)		≤6.5	≤6.5	≤6.5	≤6.5	≤6.5	≤6.5

注：以上参数有可能变动，以产品为准！
All specification is subject to modification!

沥青混合料搅拌设备

ASPHALT BATCHING PLANT

B / R5 / Z / S 系列

适合各种等级沥青混凝土路面的施工、
维护保养要求。

It can be used for any level asphalt concrete
road construction and maintenance.

沥青混合料一体机搅拌设备 / SjlB5000-R5系列 R5-Series Asphalt Mixture All-In-One Mixing Plant

总体结构 General Structure

- ① 原生机主楼采用积木堆砌方式；原生机主楼由下至上依次为接料通道、新矿粉储仓、新骨料计量过渡方箱、新骨料计量方箱、热骨料仓、方箱振动筛；
- ② 再生机主楼并在原生机后部，采用积木堆砌方式；再生机主楼由下至上依次为接料通道、成品料仓、粉料水平小车、搅拌主机、再生料计量层、再生料加热滚筒；
- ③ 再生料加热滚筒尾气经过再生料滚筒和原生料滚筒两级二次燃烧；
- ④ 袋式除尘箱体并排放置在再生机主楼后部

- ① The main building of raw-material machine is built with blocks and contains a collecting channel, a new mineral powder bin, a new aggregate metering and transition box, a new aggregate metering box, a hot aggregate bin and a box oscillating screen in the sequence from the top to the bottom;
- ② At the rear of the primary machine is the main building of reworking machine that is also piled up with blocks. The regeneration machine is composed of a collecting channel, a finished product bin, a horizontal trolley of powder, a stirring host, a metering layer of reworked material, heating drum of reworked material in the sequence from the top to the bottom;
- ③ The exhaust gas from the heating drum of reworked material can be burned secondly in the two-stage way by both the raw and reworked material drums;
- ④ The bag-type dust box is placed in parallel with the rear of main building of reworking machine.



核心部件 The Core Components

- ① 原再生机主楼环保硬封装，外观统一，符合当前环保设计理念；
- ② 搅拌主机置于旧料滚筒下方，取消了易粘料易损耗的热料皮带；
- ③ 原生机采用专利技术方箱式振动筛；
- ④ 主楼采用爬梯方箱，取消外置爬梯，安装更快捷，设备造型更整洁；
- ⑤ 矿粉方罐并列在再生主楼左侧和爬梯方箱后部，取消外置矿粉罐，设备布局更紧凑；
- ⑥ 新旧粉布置紧凑，螺旋数量少；
- ⑦ 原再生料上料配料斗在同一侧，方便料场统一规划。

- ① The main buildings of both raw-material and reworking machines are packed with rigid environment-friendly materials, featuring the unified appearance and embodying the environment-friendly concept.
- ② The stirring host is below the old material drum, eliminating the hot material belt that is easy to wear and stick material;
- ③ The raw-material machine is equipped with a patented box-type vibrating screen;
- ④ The main building is mounted with a ladder box, without external ladder, making its installation easier and equipment appearance more elegant.
- ⑤ Mineral powder box is parallel to the left of reworking building and the back of ladder-type box, eliminating external powder tank and making the equipment layout more compact;
- ⑥ The new and old powders are arranged compactly, with fewer coils;
- ⑦ For the raw and reworked materials, the loading and distributing hoppers are at the same side, making the material yard more compact.

工艺流程 Technological Process

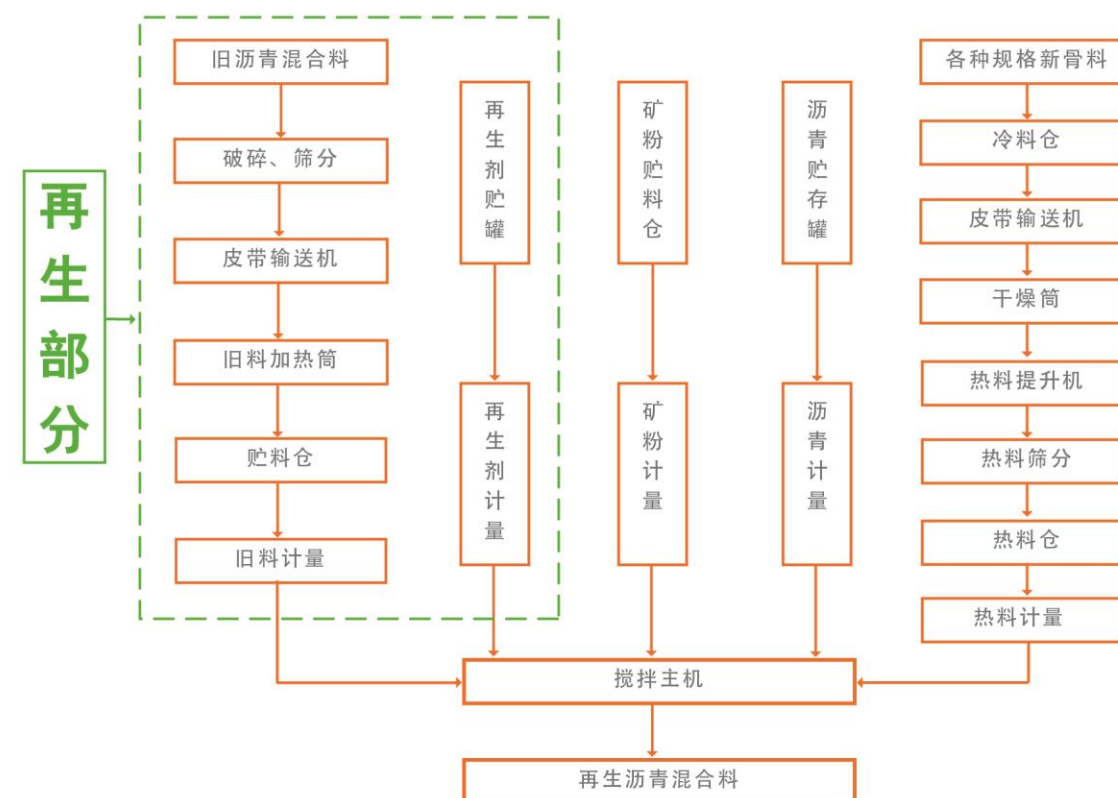

沥青厂拌热再生 / Z系列

Asphalt Plant Mixing Heat Regeneration Equipment



Z系列优点

- ① 采用顺流式热风加热技术，有效防止沥青烧损及老化；
- ② 滚筒内部采用独特的结构设计，有效防止再生料叶片粘接，大大提高热效率；
- ③ 再生料加热过程中产生的蓝烟，不直接排入大气，而是经过烟道进入沥青搅拌设备主机干燥滚筒进行二次燃烧以彻底消除有害气体；
- ④ 可根据工程需要调整添加配合比，最大再生料添加比例可达50%，环保效果显著，经济效益高；
- ⑤ 成品料质量稳定，可用于路面下面层。

Benefits of Z Series

- ① Adopt downstream hot air heating technology, effectively prevent bitumen burning and aging.
- ② The interior of the roller is designed with a unique structure, effectively prevent the regeneration of materials and blade adhesive, greatly improving thermal efficiency.
- ③ The blue smoke generated during the heating process of recycled material, not discharge directly into the atmosphere; But through the flue into the asphalt mixing equipment host dry drum for secondary combustion to completely eliminate harmful emissions.
- ④ Can be adjusted mix proportion according to the need of the project ratio, the maximum proportion of renewable materials to add up to 50%, environmental protection effect is remarkable, high economic benefit.
- ⑤ Finished product quality is stable and can be used for road surface layer below.

型号 Model	LB3000-5F	LB4000-5F	LB5000-5F
配套沥青站型号 Model of Asphalt Mixing Plant	LB3000-5B	LB4000-5B	LB5000-5B
添加再生料额定生产率 Rated capacity of adding the recycled material(t/h)	120	160	200
再生料最大添加量 The maximum amount of recycled material(kg)	1500	2000	2500
计量精度 Measuring accuracy	±0.5%	±0.5%	±0.5%
整机功率 Total Power (kW)	200	230	280

注：以上参数有可能变动，以产品为准！
All specification is subject to modification!

沥青厂拌冷再生 / S系列

Plant-mix Cold Asphalt Recycling Equipment



S系列优点

- ① 采用连续搅拌技术，设备能耗低，生产效率高；
- ② 搅拌主机采用无衬板搅拌技术，彻底避免叶片和衬板磨损，维护方便；
- ③ 再生料不再加热，直接添加乳化沥青/泡沫沥青进行再生，彻底避免再生料烧损；
- ④ 可实现再生料100%回收利用；
- ⑤ 成品料一般用于路面基层。

Benefits of S Series

- ① Continuous mixing, low energy consumption, high work efficiency.
- ② Asphalt mixer adopts lining-plate-free mixing technology, so as to avoid wearing to the mixing blade and lining plate once and for all, making it easy for maintenance.
- ③ No heating, add in emulsified asphalt/foamed asphalt directly to avoid heating damage to the recycled material.
- ④ Realizing 100% recycling of cold asphalt.
- ⑤ Finished material is generally used for road base pavement.

型号 Model	额定生产能力 Rated capacity (t/h)	骨料粒径 Agg. size (mm)	计量精度 Weighing accuracy			总功率 Total power
			骨料 Agg.	粉料 Powder	再生沥青 Recycled asphalt	
SjLRC300-3S	300	≤50	±2%	±2%	-1%±2%	270kW

注：以上参数有可能变动，以产品为准！
All specification is subject to modification!

核心部件 The Core Components

① 模块化的粒料配料系统 Modular Aggregate Batching System



- 1、粒料配料系统和电子皮带秤组装好后整体发货，减少现场工作量；
- 2、集料皮带机折叠后整体运输；
- 3、电子皮带秤采用变频控制，自动调节给料量，计量精度高。

1. Aggregate batching system and electronic belt scale are delivered together after being assembled, so as to reduce workload on site.
2. Aggregate belt conveyor is entirely delivered after being folded.
3. Electronic belt scale adopts variable-frequency control technology, featuring high weighing accuracy.

② 精确的粉料计量系统 Accurate Powder Weighing System



- 1、粉料计量系统采用矢量秤，矢量秤是动态螺旋秤与静态减量秤的完美结合，通过减量秤实时标定螺旋秤，只需初始校减量秤，减少人工且计量精度高；
- 2、螺旋电子秤全部厂内试验后发货，确保计量精度；
- 3、设置大出口水泥减量秤及大角度调速螺旋，有效防止料仓水泥起拱及水泥溢料，确保料流均匀稳定；
- 4、粉料称量整个过程处于全密封状态，无粉尘外溢，环保性能优异。

1. The powder metering system adopts the vector scale. The vector scale is the perfect combination of the dynamic spiral scale and the static reduction scale. The spiral scale is calibrated in real time by the reduction scale, and only the initial calibration scale is reduced, which reduces the manual and high measurement accuracy.
2. All screw electronic scale are tested in lab before leaving factory.
3. Set up the big export cement reduction scale and large angle speed adjustment screw, effectively prevent the bin cement arch and cement overflow, ensure the material flow is uniform and stable.
4. The whole process of powder weighing is in a fully sealed state, without dust overflow, with excellent environmental performance.

③ 高效的搅拌系统 Efficient Mixing System



- 1、采用两台轴装减速机驱动，结构简单，运行平稳；
- 2、内部搅拌臂和搅拌叶片全部采用螺栓连接，便于检修更换；
- 3、采用双轴高转速搅拌，搅拌剧烈，搅拌均匀；
- 4、采用无衬板技术，彻底消除更换衬板的烦恼而且使搅拌叶片磨损大大降低，更加耐用。

1. It has two direct-connected gear reducers and simple structure, smooth operation.
2. The mixing arm and blade are connected by bolt which is easy for repairing.
3. It adopts double-shaft with high speed mixing and mixes evenly and fast.
4. With no lining design, it is no need to change of the lining plate which reduces the wear and is more durable.

④ 先进的控制系统 Advanced Control System



- 1、采用先进的集中微机配料控制系统，物料的配比精度和整机的工作效率都得到大大提高；
- 2、拥有强大的管理功能，报表管理统计信息完全，能够方便地查询信息及设定用户信息，能够直观地用图示模拟配料生产状况；
- 3、设备从配料、上料、搅拌、出料实现生产过程控制，具有完善的自锁、互锁功能，保证系统准确、可靠地运行。

1. Adopts advanced microcomputer batching control system, material proportioning accuracy and efficiency of the machine have been greatly improved.
2. It has strong management capabilities with complete statistics report management, can conveniently query and set information and be able to visually using graphic simulate production status.
3. The production process control from the batching, loading, mixing and discharging, have perfect self-locking, interlocking function which guarantee the system running accurately and reliably.

稳定土拌合站 / B系列

Stabilized Soil Plant Mixing Equipment



B系列优点

- ① 搅拌主机采用无衬板搅拌技术，彻底避免叶片和衬板磨损，维护方便；
- ② 所有物料均采用电子计量秤进行计量，变频调速控制，计量精度更高；
- ③ 采用先进的集中微机配料控制系统，物料的配比精度和整机的工作效率都得到大大提高；
- ④ 模块化的结构设计，安装方便，转场迅速。

Benefits of B Series

- ① Concrete mixer adopts lining-plate-free mixing technology, so as to avoid wearing to the mixing blade and lining plate once and for all, making it easy for maintenance.
- ② All materials are weighed up in electronic scale, which is controlled by variable frequency converter, featuring high weighing accuracy.
- ③ Adopting advanced centralized aggregate batching control system, so that batching accuracy and work efficiency of the whole plant can both be improved.
- ④ Modular structure, easy installation and rapid plant transfer.

型号 Model		WBZ300-3B	WBZ400-3B	WBZ500-3B	WBZ600-3B	WBZ700-3B	WBZ800-3B	WBZ10AB
额定生产率 (t/h) Rated capacity		300	400	500	600	700	800	1000
搅拌主机 Mixer	搅拌功率(kW) Power	2x22	2x22	2x30	2x37	2x37	2x45	2x75
	骨料粒径(mm) Agg.Size	≤50	≤50	≤50	≤50	≤50	≤50	≤50
骨料仓容积(m³) Agg.bins capacity		3x12	3x12	4x12	5x12	5x12	5x15	5x15
皮带机输送能力(t/h) Belt conveyor capacity		300	400	500	600	700	800	1000
计量精度 Weighing accuracy	骨料(kg) Agg.	±2%	±2%	±2%	±2%	±2%	±2%	±2%
	水泥(kg) Cement	±1%	±1%	±1%	±1%	±1%	±1%	±1%
	水(kg) Water	±1%	±1%	±1%	±1%	±1%	±1%	±1%
总功率(kW) Total power		110	110	137	157	157	193	262
卸料高度 (m) Discharging height		3.6	3.6	3.6	3.6	3.6	3.6	3.6

注：以上参数有可能变动，以产品为准！ All specification is subject to modification!

双搅拌稳定土拌合站 / S系列

Double Mixing Stabilized Soil Plant Mixing Equipment



S系列优点

- ① 搅拌主机采用无衬板搅拌技术，彻底避免叶片和衬板磨损，维护方便；
- ② 所有物料均采用电子计量秤进行计量，变频调速控制，计量精度更高；
- ③ 采用先进的集中微机配料控制系统，物料的配比精度和整机的工作效率都得到大大提高；
- ④ 模块化的结构设计，安装方便，转场迅速。

Benefits of S Series

- ① Concrete mixer adopts lining-plate-free mixing technology, so as to avoid wearing to the mixing blade and lining plate once and for all, making it easy for maintenance.
- ② All materials are weighed up in electronic scale, which is controlled by variable frequency converter, featuring high weighing accuracy.
- ③ Adopting advanced centralized aggregate batching control system, so that batching accuracy and work efficiency of the whole plant can both be improved.
- ④ Modular structure, easy installation and rapid plant transfer.

型号 Model		WBZ300-3S	WBZ400-3S	WBZ500-3S	WBZ600-3S	WBZ700-3S	WBZ800-3S	WBZ10AB
额定生产率 (t/h) Rated capacity		300	400	500	600	700	800	1000
搅拌主机 Mixer	搅拌功率(kW) Power	2x2x22	2x2x22	2x2x30	2x2x37	2x2x37	2x2x45	2x2x75
	骨料粒径(mm) Agg.Size	≤50	≤50	≤50	≤50	≤50	≤50	≤50
骨料仓容积 (m³) Agg.bins capacity		4x12	4x12	4x12	5x12	5x12	5x15	5x15
皮带机输送能力 (t/h) Belt conveyor capacity		300	400	500	600	700	800	1000
计量精度 Weighing accuracy	骨料(kg) Agg.	±2%	±2%	±2%	±2%	±2%	±2%	±2%
	水泥(kg) Cement	±1%	±1%	±1%	±1%	±1%	±1%	±1%
	水(kg) Water	±1%	±1%	±1%	±1%	±1%	±1%	±1%
总功率(kW) Total power		162	162	208	243	243	295	435
卸料高度 (m) Discharging height		3.6	3.6	3.6	3.6	3.6	3.6	3.6

注：以上参数有可能变动，以产品为准！ All specification is subject to modification!

工程案例 Project

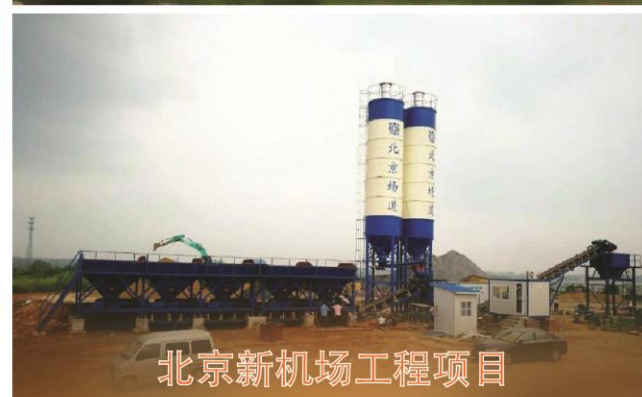
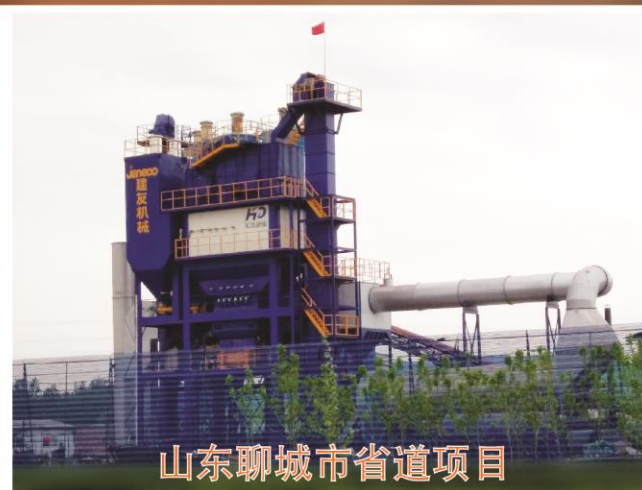

生产工艺 Manufacturing Technique

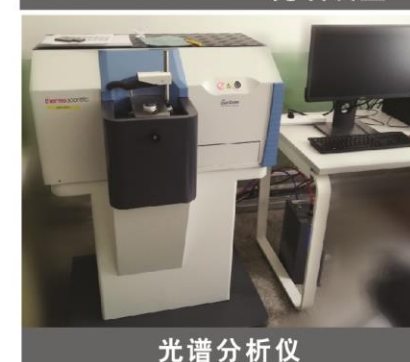
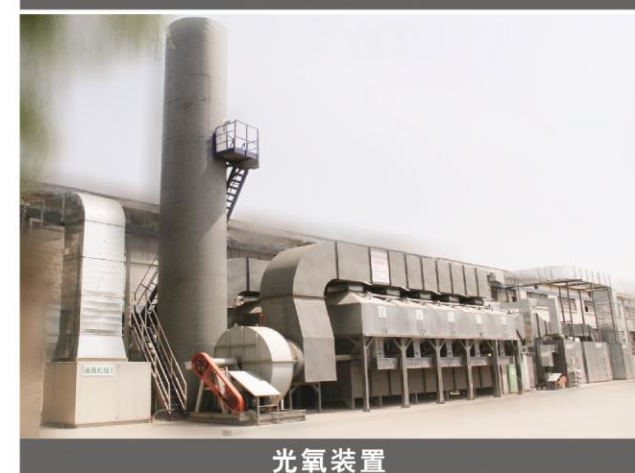

产品备件供应系统

专注工程机械搅拌站行业六十余年，山推建友本着为客户提供质量合格的纯正配件，保姆式服务的经营理念，为客户提供优质产品和服务。

- 拥有完善的配件供应系统，强大的配件仓库，各网络销售以及纯正原厂部件，为用户及时解决设备问题，确保工程顺利完成，为用户创造价值。
- 专注旧站升级改造解决方案，彻底解决旧站运行中遇到的：设备产量低，生产效率不高，智能化水平低、计量不准，生产成本低，环保不达标、微机系统不能满足生产需求等难题，进一步满足高端客户对设备性能、环保的要求，为客户创造更多价值。

原装配件



设备改造



服务关怀

全程服务 轻松无忧

山推建友以“客户满意”为宗旨，为客户提供最优方案，以专业化团队、专家级解答、保姆式服务，为客户提供售前、售中、售后全生命周期的服务，让专业赢得信任，服务共创未来！

快速响应

- 2+4+8 模式
- 2小时响应
- 4小时到达
- 8小时解决问题
- 24小时全时段服务

质量保证

质保期为设备经试验合格之日起满**12**个月实行“三包”，可享受终生服务

培训咨询

- 线上培训
- 实地培训

视客户需求，协助操作者培训取证
培训内容涵盖基本操作、基本保养、简单故障排除、电气控制系统等各方面

服务体系

山推建友拥有服务工程师**85**人，服务车辆**20**辆，在主要省会城市设有办事处，在海外拥有**30**多个售后服务网点。加之依托山推股份完备的服务网络，可实现全球设备服务轻松无忧
针对重点项目，山推建友单独设立服务站或项目组，让产品安装调试、故障诊断、技术培训、产品回访等工作更加便捷、高效

